

\$10,000,000 - 4-24-50-6- Nw, Nisku

MLS® #E4420182

\$10,000,000

0 Bedroom, 0.00 Bathroom,
Single Family on 0.00 Acres

Nisku, Nisku, AB

80 Acres. Located in the Northwest Saunders Lake ASP; Five minute drive to Edmonton International Airport; Adjacent to Leduc city limits and 10 minutes to Leduc core; Parcels can be purchased together or separately; Located south of Nisku Business Park; ; Parcel Size: 80 AC + 160 AC + 160 AC=400 Acres. Zoning: AG (Agriculture). Legal Description: West 80 - 4;24;50;6;NW East 160 - 4; 24;50;6;NE - West 160 - 4;24;50;7;SW. Information herein and auxiliary information subject to becoming outdated in time, change, and/or deemed reliable but not guaranteed.

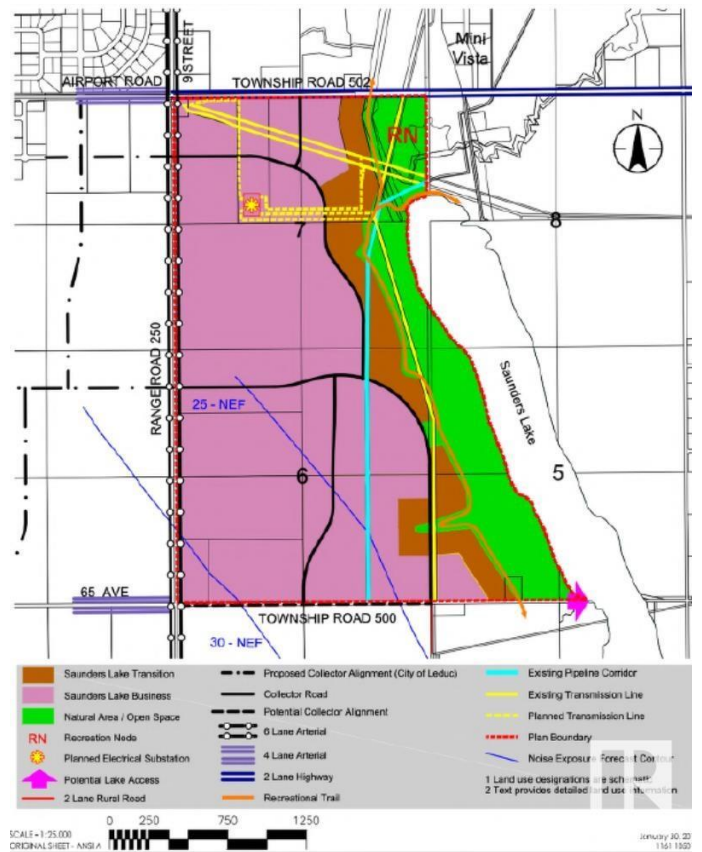

Essential Information

MLS® #	E4420182
Price	\$10,000,000
Bathrooms	0.00
Acres	0.00
Type	Single Family
Sub-Type	Vacant Lot/Land
Status	Active

Community Information

Address	4-24-50-6- Nw
Area	Nisku
Subdivision	Nisku
City	Nisku



County ALBERTA
Province AB
Postal Code T9E 0A0

Exterior

Exterior Features See Remarks

Additional Information

Date Listed February 1st, 2025
Days on Market 82
Zoning Zone 81

DATA IS DEEMED RELIABLE BUT IS NOT GUARANTEED ACCURATE BY THE REALTORS® ASSOCIATION OF EDMONTON. COPYRIGHT 2025 BY THE REALTORS® ASSOCIATION OF EDMONTON. ALL RIGHTS RESERVED. Trademarks are owned or controlled by the Canadian Real Estate Association (CREA) and identify real estate professionals who are members of CREA (REALTOR®, REALTORS®) and/or the quality of services they provide (MLS®, Multiple Listing Service®)

Listing information last updated on April 24th, 2025 at 8:32pm MDT